

## Molded IEEE-488 Cable, 2.0m

### Features for this product

- Cable meets IEEE-488 standards for connecting peripherals where EMI is an issue
- 30 microinch gold contact plating provides reliable connections with repeated mating cycles
- Custom stamped steel internal enclosure provides 100% shielding and a robust strain relief
- Molded backshells provide durability and increased strength at cable entry point
- Color: Gray



Supreme performance combined with rugged durability make this cable series a great value. Featuring an outer braid plus foil shield, these cables provide for enhanced protection against EMI (electromagnetic interference). A unique stamped steel internal enclosure provides 100% shielding and a robust strain relief. Molded backshells contribute to a long life expectancy and resist breakage at the point where the cable enters the backshell. This combination of features ensures a highly reliable cable that will pass stringent emissions testing while providing years of trouble free service. Custom modifications are available with modest minimum requirements.

### Details for this IEEE-488 GPIB product

L-com Item #	CMB24-2M
Manufacturer	L-com
UPC #	822335011298
RoHS Status	<a href="#">RoHS Compliant</a> 
Connector Orientation	Normal / Normal

**Standard vs. Ultra-flex video**

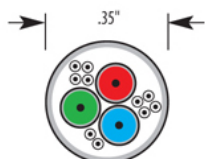

Standard video cabling with standard coaxials

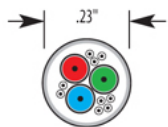

NEW Super Thin video cabling with micro coaxials

**Fits through 3/4" conduit**

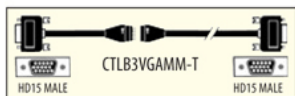

Item #	Description	#Coax
--------	-------------	-------

**SVGA Cables with Low Profile Disconnect Feature - HD15 Male to HD15 Male**

Now there is a solution to your difficult installation problems. A fully populated DDC compliant assembly with (2) HD15 male connectors utilizing our Super Thin cable, reversible hardware plus a low profile break connector. The low profile break connector's small size (.75" wide) allows routing through 3/4" conduit and through tight spaces that would not accommodate the size of a HD15 connector. Color: Black.

<a href="#">CTLB3VGAMM-15T</a>	Super Thin SVGA Cable, HD15 Male / Male, 15.0 ft	3
<a href="#">CTLB3VGAMM-20T</a>	Super Thin SVGA Cable, HD15 Male / Male, 20.0 ft	3
<a href="#">CTLB3VGAMM-25T</a>	Super Thin SVGA Cable, HD15 Male / Male, 25.0 ft	3
<a href="#">CTLB3VGAMM-50T</a>	Super Thin SVGA Cable, HD15 Male / Male, 50.0 ft	3
<a href="#">CTLB3VGAMM-75T</a>	Super Thin SVGA Cable, HD15 Male / Male, 75.0 ft	3

**Plenum Jacket SVGA Cables with Low Profile Disconnect Feature - HD15 Male to HD15 Male**

This series is identical to our SVGA cables with one important exception, the outer jacket is made from CMP grade plenum material for applications where fire resistance and low smoke characteristics are critical. Color: Black.

<a href="#">CTLB3VGAMM-15TP</a>	Super Thin Plenum SVGA Cable, HD15 Male / Male, 15.0 ft	3
<a href="#">CTLB3VGAMM-20TP</a>	Super Thin Plenum SVGA Cable, HD15 Male / Male, 20.0 ft	3
<a href="#">CTLB3VGAMM-25TP</a>	Super Thin Plenum SVGA Cable, HD15 Male / Male, 25.0 ft	3
<a href="#">CTLB3VGAMM-50TP</a>	Super Thin Plenum SVGA Cable, HD15 Male / Male, 50.0 ft	3
<a href="#">CTLB3VGAMM-75TP</a>	Super Thin Plenum SVGA Cable, HD15 Male / Male, 75.0 ft	3

**LSZH Jacket SVGA Cables with Low Profile Disconnect Feature - HD15 Male to HD15 Male**

This series features a fully populated DDC compliant assembly with (2) low profile HD15 male connectors and our low smoke zero halogen Super Thin cable. An additional feature is our unique user defined mounting hardware plus a low profile break connector which allows routing through 3/4" conduit and other tight spaces. Offered in standard lengths of 15, 20, 25, 50 and 75 feet with a 1 foot lead in length to the low profile connector.

<a href="#">CTLB3VGAMM-15TZ</a>	Super Thin LSZH SVGA Cable, HD15 Male / Male, 15.0 ft	3
<a href="#">CTLB3VGAMM-20TZ</a>	Super Thin LSZH SVGA Cable, HD15 Male / Male, 20.0 ft	3
<a href="#">CTLB3VGAMM-25TZ</a>	Super Thin LSZH SVGA Cable, HD15 Male / Male, 25.0 ft	3
<a href="#">CTLB3VGAMM-50TZ</a>	Super Thin LSZH SVGA Cable, HD15 Male / Male, 50.0 ft	3
<a href="#">CTLB3VGAMM-75TZ</a>	Super Thin LSZH SVGA Cable, HD15 Male / Male, 75.0 ft	3



**Tip** Using CTLB series cable for running through 3/4" conduit



STEP 1  
Feed socket end through conduit (3/4" min. dia.) into destination outlet.



STEP 2  
Slip shrinkable tubing onto cable, mate the breakaway connector matching alignment arrows and secure.

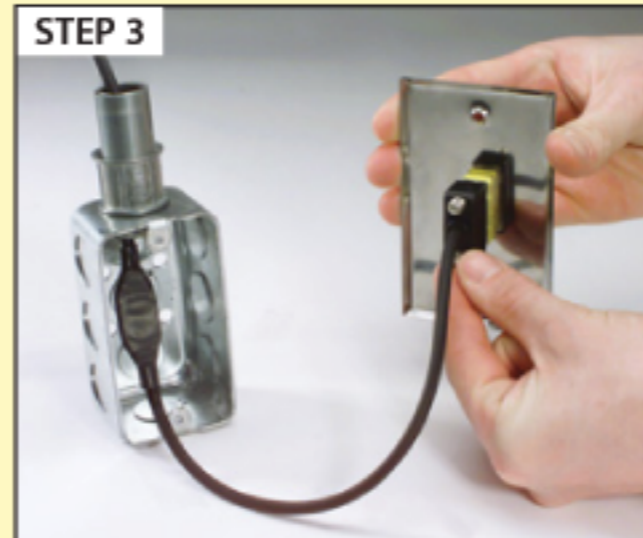

STEP 3  
Attach pre-terminated HD15 connector to faceplate and attach to outlet.

**Video Wallplate Assemblies**

Combining our innovative field termination style HD15 and Mini DIN 4 (SVHS) as well as a HD15 female pigtail with our stainless steel wallplates L-com now offers a convenient series of preassembled wallplate assemblies for your field installation applications.

<a href="#">WPHD15FT</a>	Wallplate Assembly, HD15 Female
<a href="#">WPMF44FT</a>	Wallplate Assembly, MD44 (S-Video) Female
<a href="#">WPHD15C</a>	Wallplate Assembly, HD15 Female to 5 BNC Female 2 ft Pigtail

**Solder Type Mini DIN 4 Connectors with Metal Cover For SVHS Assemblies**

<a href="#">BAC-MD4M</a>	SVHS Mini DIN 4 Connector, Male
<a href="#">BAC-MD4F</a>	SVHS Mini DIN 4 Connector, Female

**Bulkhead Feed-Thru Adapter for SVHS Mini DIN 4 - Fits 1/2" Diameter D-hole**

<a href="#">MD44F</a>	Bulkhead Feed-Thru Adapter, Female / Female
-----------------------	---

**Bulk SVGA Cable - Double Shielded with (3) 75 Ohm Coaxial Lines Plus Conductors**

This is the same bulk cable used in our premium grade SVGA assemblies. The three coaxial lines are double shielded enhancing video performance. In addition the bulk cable construction includes four 26AWG twisted pairs and two 26AWG conductors. Used in conjunction with our D-Sub connectors you can now fabricate your own SVGA cable assemblies. Color: Black.

<a href="#">CTL3VGA-250</a>	SVGA Bulk Cable, 250.0 ft
<a href="#">CTL3VGA-500</a>	SVGA Bulk Cable, 500.0 ft

**Bulk Super Thin SVGA Cable - Double Shielded - (3) 75 Ohm Coaxial Lines Plus Conductors**

This is the same bulk cable used in our Thinline series SVGA assemblies. The three coaxial lines are double shielded enhancing video performance. In addition the bulk cable construction includes nine stranded 30AWG conductors. Used in conjunction with our D-Sub connectors you can now fabricate your own Super Thin SVGA cable assemblies.

<a href="#">CTL3VGA-250T</a>	Super Thin SVGA Bulk Cable, 250.0 ft
<a href="#">CTL3VGA-500T</a>	Super Thin SVGA Bulk Cable, 500.0 ft

**SVHS Bulk Cable - Dual 75 Ohm Coaxials - High Flex Round PVC Jacket**

<a href="#">R1088-100</a>	Bulk S-Video Cable, 100.0 ft
<a href="#">R1088-500</a>	Bulk S-Video Cable, 500.0 ft
<a href="#">R1088-1K</a>	Bulk S-Video Cable, 1000.0 ft

